

VIRTUOSO WHIRLPOOL MODEL NUMBER

7236.028 7236.028H

American Standard

With "System II" Control System as of 2/95

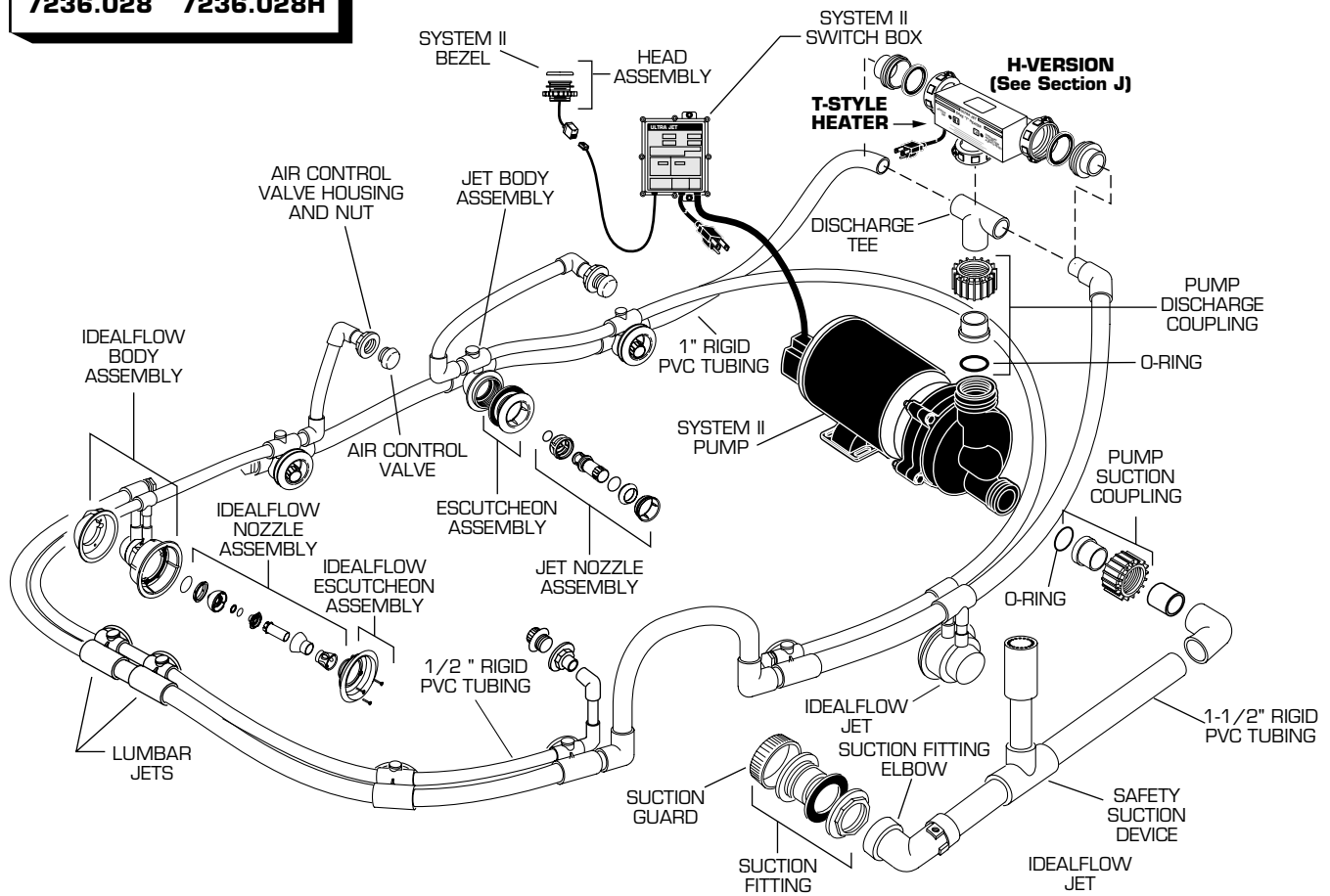

USABLE ON	DESCRIPTION	PART NUMBER	PKG QTY
ALL MODELS	Pump Suction Coupling	047186-0070A	1
	O-Ring	047187-0070A	1
	Pump Discharge Coupling	047186-0070A	1
	Pump (2 Speed, 2 HP)	752466-0070A	1
	★ Air Control Valve	751677-XXX0A	1
	★ Air Control Valve Housing/Nut	068917-XXX0A	1
	★ Jet Nozzle Assembly Δ	047587-XXX0A	1
	★ Escutcheon Assembly \square	047588-XXX0A	1
	Jet Body Assembly	047589-0070A	1
	★ Idealflow Nozzle Assembly	752407-XXX0A	1
	★ Idealflow Escutcheon Assembly	752408-XXX0A	1
	Idealflow Body Assembly	752409-0070A	1
	★ Suction Guard	750537-XXX0A	1
	★ Suction Fitting	752396-XXX0A	1
	Suction Fitting Elbow	751186-0070A	1
	Discharge Tee	047438-0070A	1
	Safety Suction Device (8")	752361-0070A	1
	★ Head Assembly \circ	752118-YYY0A	1
	★ System II Bezel \circ	752115-YYY0A	1
	Switch Box	752468-0070A	1
.028H	Heater (.028H only) See Section J	752356-0070A	1

\circ Available in Chrome and Polished Brass.

NOTE: Schedule 40 Rigid PVC Piping available through local plumbing supply outlets.

See Section "J" for Additional Parts and Accessories.

Δ Removal/installation requires tool part no. 047530-0070A.

\square Removal/installation requires tool part no. 047605-0070A.

★ Replace XXX with Fixture Color Code, YYY with Trim Finish Code; see page VII